

Buyer Info Packet

2525 Forest Run Dr. , Melbourne, FL 32935

<i>SPD</i>	<i>2</i>
<i>Flood Disclosure</i>	<i>6</i>
<i>HOA Disclosure</i>	<i>7</i>
<i>HOA Info Sheet</i>	<i>9</i>
<i>Features List</i>	<i>10</i>
<i>PPI</i>	<i>11</i>
<i>FAQ</i>	<i>12</i>
<i>Floor Plan</i>	<i>13</i>

Seller's Property Disclosure – Residential

COMPASS

Notice to Licensee and seller: Only the Seller should fill out this form.

Notice to Seller: Florida law¹ requires a Seller of a home to disclose to the Buyer all known facts that materially affect the value of the property being sold and that are not readily observable or known by the Buyer. This disclosure form is designed to help you comply with the law. However, this disclosure form may not address every significant issue that is unique to the Property. You should think about what you would want to know if you were buying the Property today; and if you need more space for additional information, comments, or explanations, check the Paragraph 12 checkbox and attach an addendum.

Notice to Buyer: The following representations are made by Seller and not by any real estate licensee. This disclosure is not a guaranty or warranty of any kind. It is not a substitute for any inspections, warranties, or professional advice you may wish to obtain. It is not a substitute for your own personal judgment and common sense. The following information is based only upon Seller's actual knowledge of the Property's condition. Sellers can disclose only what they actually know. Seller may not know about all material or significant items. You should have an independent, professional home inspection to verify the condition of the Property and determine the cost of repairs, if any. This disclosure is not a contract and is not intended to be a part of any contract for sale and purchase.

Seller makes the following disclosure regarding the property described as: 2525 Forest Run Dr.
Melbourne FL 32935 Lot 9 block F (the "Property")

The Property is ☒ Owner occupied ☐ Tenant occupied ☐ Unoccupied (If unoccupied, how long has it been since Seller occupied the Property? _____)

1. Structures; Systems; Appliances

- (a) Are the structures including roofs: ceilings; walls; doors; windows; foundation; and pool, hot tub, and spa, if any, structurally sound and free of leaks? ☒ Yes ☐ No ☐ Don't Know
- (b) Is seawall, if any, and dockage, if any, structurally sound? ☐ Yes ☐ No ☒ Don't Know
- (c) Are existing major appliances and heating, cooling, mechanical, electrical, security, and sprinkler systems, in working condition, i.e., operating in the manner in which the item was designed to operate? ☒ Yes ☐ No ☐ Don't Know
- (d) Does the Property have aluminum wiring other than the primary service line? ☐ Yes ☒ No ☐ Don't Know
- (e) Are any of the appliances leased? If yes, which ones: _____
- (f) If any answer to questions 1(a) - 1(c) is no, please explain: _____

2. Termites; Other Wood-Destroying Organisms; Pests

- (a) Are termites; other wood-destroying organisms, including fungi; or pests present on the Property or has the Property had any structural damage by them? ☐ Yes ☒ No ☐ Don't Know
- (b) Has the Property been treated for termites; other wood-destroying organisms, including fungi; or pests? ☐ Yes ☒ No ☐ Don't Know
- (c) If any answer to questions 2(a) - 2(b) is yes, please explain: _____

3. Water Intrusion; Drainage; Flooding

- (a) Has past or present water intrusion affected the Property? ☒ Yes ☐ No ☐ Don't Know
- (b) Have past or present drainage or flooding problems affected the Property? ☐ Yes ☒ No ☐ Don't Know
- (c) Is any of the Property located in a special flood hazard area? ☐ Yes ☒ No ☐ Don't Know
- (d) Is any of the Property located seaward of the coastal construction control line? ☐ Yes ☒ No ☐ Don't Know
- (e) Does your lender require flood insurance? ☐ Yes ☒ No ☐ Don't Know
- (f) Do you have an elevation certificate? If yes, please attach a copy. ☐ Yes ☒ No ☐ Don't Know
- (g) If any answer to questions 3(a) - 3(d) is yes, please explain: old windows/cracks in stucco lead to water intrusion during hurricane. All damage repaired and windows replaced. No further intrusion in subsequent hurricanes.

¹ Johnson v. Davis, 50 So.2d 625 (Fla. 1985).

Seller SOX and Buyer _____ acknowledge receipt of a copy of this page, which is Page 1 of 4.

SPDR-3 Rev 2/20
 Serial/F: 005737-300158-6207788

©2020 Florida Realtors®

Form
 Simplicity

	Yes	No	Don't Know
4. Plumbing			
(a) What is your drinking water source? <input checked="" type="checkbox"/> public <input type="checkbox"/> private <input type="checkbox"/> well <input type="checkbox"/> other	<input type="checkbox"/>	<input checked="" type="checkbox"/>	<input type="checkbox"/>
(b) Have you ever had a problem with the quality, supply, or flow of potable water?	<input type="checkbox"/>	<input checked="" type="checkbox"/>	<input type="checkbox"/>
(c) Do you have a water treatment system?	<input type="checkbox"/>	<input checked="" type="checkbox"/>	<input type="checkbox"/>
If yes, is it <input type="checkbox"/> owned <input type="checkbox"/> leased?			
(d) Do you have a <input checked="" type="checkbox"/> sewer or <input type="checkbox"/> septic system? If septic system, describe the location of each system: _____			
(e) Are any septic tanks, drain fields, or wells that are not currently being used located on the Property?	<input type="checkbox"/>	<input checked="" type="checkbox"/>	<input type="checkbox"/>
(f) Are there or have there been any defects to the water system, septic system, drain fields or wells?	<input type="checkbox"/>	<input checked="" type="checkbox"/>	<input type="checkbox"/>
(g) Have there been any plumbing leaks since you have owned the Property?	<input checked="" type="checkbox"/>	<input type="checkbox"/>	<input type="checkbox"/>
(h) Are any polybutylene pipes on the Property?	<input type="checkbox"/>	<input type="checkbox"/>	<input checked="" type="checkbox"/>
(i) If any answer to questions 4(b), 4(c), and 4(e) - 4(h) is yes, please explain: "unusual" pin hole slab leak in kitchen. Repaired. Kitchen has since been remodeled.			
5. Roof and Roof-Related Items			
(a) To your knowledge, is the roof structurally sound and free of leaks?	<input checked="" type="checkbox"/>	<input type="checkbox"/>	<input type="checkbox"/>
(b) The age of the roof is <u>10</u> years OR date installed _____	<input type="checkbox"/>	<input checked="" type="checkbox"/>	<input type="checkbox"/>
(c) Has the roof ever leaked during your ownership?	<input type="checkbox"/>	<input checked="" type="checkbox"/>	<input type="checkbox"/>
(d) To your knowledge, has there been any repair, restoration, replacement (indicate full or partial) or other work undertaken on the roof? If yes, please explain: Minor shingle replacement + post hurricane	<input checked="" type="checkbox"/>	<input type="checkbox"/>	<input type="checkbox"/>
(e) Are you aware of any defects to the roof, fascia, soffits, flashings or any other component of the roof system? If yes, please explain: _____	<input type="checkbox"/>	<input checked="" type="checkbox"/>	<input type="checkbox"/>
6. Pools; Hot Tubs; Spas			
Note: Florida law requires swimming pools, hot tubs, and spas that received a certificate of completion on or after October 1, 2000, to have at least one safety feature as specified by Section 515.27, Florida Statutes.			
(a) If the Property has a swimming pool, hot tub, or spa that received a certificate of completion on or after October 1, 2000, indicate the existing safety feature(s): <input type="checkbox"/> enclosure that meets the pool barrier requirements <input type="checkbox"/> approved safety pool cover <input type="checkbox"/> required door and window exit alarms <input type="checkbox"/> required door locks <input type="checkbox"/> none	<input type="checkbox"/>	<input type="checkbox"/>	<input checked="" type="checkbox"/>
(b) Has an in-ground pool on the Property been demolished and/or filled?	<input type="checkbox"/>	<input type="checkbox"/>	<input checked="" type="checkbox"/>
7. Sinkholes			
Note: When an insurance claim for sinkhole damage has been made by the Seller and paid by the insurer, Section 627.7073(2)(c), Florida Statutes, requires the Seller to disclose to the Buyer that a claim was paid and whether or not the full amount paid was used to repair the sinkhole damage.			
(a) Does past or present settling, soil movement, or sinkhole(s) affect the Property or adjacent properties?	<input type="checkbox"/>	<input checked="" type="checkbox"/>	<input type="checkbox"/>
(b) Has any insurance claim for sinkhole damage been made? If yes, was the claim paid? <input type="checkbox"/> yes <input type="checkbox"/> no If the claim was paid, were all the proceeds used to repair the damage? <input type="checkbox"/> yes <input type="checkbox"/> no	<input type="checkbox"/>	<input checked="" type="checkbox"/>	<input type="checkbox"/>
(c) If any answer to questions 7(a) - 7(b) is yes, please explain: _____			

Seller (SOK) () and Buyer () () acknowledge receipt of a copy of this page, which is Page 2 of 4.

SPDR-3 Rev 2/20
Serial#: 005737-300158-6207788

©2020 Florida Realtors®

Form
Simplicity

	Yes	No	Don't Know
8. Homeowners' Association Restrictions; Boundaries; Access Roads			
(a) Is membership in a homeowner's association mandatory or do any covenants, conditions or restrictions (CCRs) affect the Property? (CCRs include deed restrictions, restrictive covenants and declaration of covenants.) Notice to Buyer: If yes, you should read the association's official records and/or the CCRs before making an offer to purchase. These documents contain information on significant matters, such as recurring dues or fees; special assessments; capital contributions, penalties; and architectural, building, landscaping, leasing, parking, pet, resale, vehicle and other types of restrictions.	<input checked="" type="checkbox"/>	<input type="checkbox"/>	<input type="checkbox"/>
(b) Are there any proposed changes to any of the restrictions?	<input type="checkbox"/>	<input type="checkbox"/>	<input checked="" type="checkbox"/>
(c) Are any driveways, walls, fences, or other features shared with adjoining landowners?	<input checked="" type="checkbox"/>	<input type="checkbox"/>	<input type="checkbox"/>
(d) Are there any encroachments on the Property or any encroachments by the Property's improvements on other lands?	<input type="checkbox"/>	<input checked="" type="checkbox"/>	<input type="checkbox"/>
(e) Are there boundary line disputes or easements affecting the Property?	<input type="checkbox"/>	<input checked="" type="checkbox"/>	<input type="checkbox"/>
(f) Are you aware of any existing, pending or proposed legal or administrative action affecting homeowner's association common areas (such as clubhouse, pools, tennis courts or other areas)?	<input type="checkbox"/>	<input checked="" type="checkbox"/>	<input type="checkbox"/>
(g) Have any subsurface rights, as defined by Section 689.29(3)(b), Florida Statutes, been severed from the Property? If yes, is there a right of entry? <input type="checkbox"/> yes <input type="checkbox"/> no	<input type="checkbox"/>	<input type="checkbox"/>	<input checked="" type="checkbox"/>
(h) Are access roads <input type="checkbox"/> private <input checked="" type="checkbox"/> public? If private, describe the terms and conditions of the maintenance agreement: _____			
(i) If any answer to questions 8(a) - 8(g) is yes, please explain: <u>Some fences may be on property line shared by parties.</u>			
9. Environmental			
(a) Was the Property built before 1978? If yes, please see Lead-Based Paint Disclosure.	<input type="checkbox"/>	<input checked="" type="checkbox"/>	<input type="checkbox"/>
(b) Does anything exist on the Property that may be considered an environmental hazard, including but not limited to, lead-based paint; asbestos; mold; urea formaldehyde; radon gas; methamphetamine contamination; defective drywall; fuel, propane, or chemical storage tanks (active or abandoned); or contaminated soil or water?	<input type="checkbox"/>	<input checked="" type="checkbox"/>	<input type="checkbox"/>
(c) Has there been any damage, clean up, or repair to the Property due to any of the substances or materials listed in subsection (b) above?	<input type="checkbox"/>	<input checked="" type="checkbox"/>	<input type="checkbox"/>
(d) Are any mangroves, archeological sites, or other environmentally sensitive areas located on the Property?	<input type="checkbox"/>	<input checked="" type="checkbox"/>	<input type="checkbox"/>
(e) If any answer to questions 9(b) - 9(d) is yes, please explain: _____			
10. Governmental, Claims and Litigation			
(a) Are there any existing, pending or proposed legal or administrative claims affecting the Property?	<input type="checkbox"/>	<input checked="" type="checkbox"/>	<input type="checkbox"/>
(b) Are you aware of any existing or proposed municipal or county special assessments affecting the Property?	<input type="checkbox"/>	<input checked="" type="checkbox"/>	<input type="checkbox"/>
(c) Is the Property subject to any Property Assessed Clean Energy (PACE) assessment per Section 163.08, Florida Statutes?	<input type="checkbox"/>	<input type="checkbox"/>	<input checked="" type="checkbox"/>
(d) Are you aware of the Property ever having been, or is it currently, subject to litigation or claim, including but not limited to, defective building products, construction defects and/or title problems?	<input type="checkbox"/>	<input checked="" type="checkbox"/>	<input type="checkbox"/>
(e) Have you ever had any claims filed against your homeowner's Insurance Policy?	<input type="checkbox"/>	<input checked="" type="checkbox"/>	<input type="checkbox"/>

Seller SOX (____) and Buyer (____) (____) acknowledge receipt of a copy of this page, which is Page 3 of 4.

SPDR-3 Rev 2/20
Serial#: 005737-300158-6207788

©2020 Florida Realtors®

Form
Simplicity

- | | Yes | No | Don't Know |
|--|--------------------------|-------------------------------------|--------------------------|
| (f) Are there any zoning violations or nonconforming uses? | <input type="checkbox"/> | <input checked="" type="checkbox"/> | <input type="checkbox"/> |
| (g) Are there any zoning restrictions affecting improvements or replacement of the Property? | <input type="checkbox"/> | <input checked="" type="checkbox"/> | <input type="checkbox"/> |
| (h) Do any zoning, land use or administrative regulations conflict with the existing use of the Property? | <input type="checkbox"/> | <input checked="" type="checkbox"/> | <input type="checkbox"/> |
| (i) Do any restrictions other than association or flood area requirements, affect improvements or replacement of the Property? | <input type="checkbox"/> | <input checked="" type="checkbox"/> | <input type="checkbox"/> |
| (j) Are any improvements located below the base flood elevation? | <input type="checkbox"/> | <input checked="" type="checkbox"/> | <input type="checkbox"/> |
| (k) Have any improvements been constructed in violation of applicable local flood guidelines? | <input type="checkbox"/> | <input checked="" type="checkbox"/> | <input type="checkbox"/> |
| (l) Have any improvements to the Property, whether by you or by others, been constructed in violation of building codes or without necessary permits? | <input type="checkbox"/> | <input checked="" type="checkbox"/> | <input type="checkbox"/> |
| (m) Are there any active permits on the Property that have not been closed by a final inspection? | <input type="checkbox"/> | <input checked="" type="checkbox"/> | <input type="checkbox"/> |
| (n) Is there any violation or non-compliance regarding any unrecorded liens; code enforcement violations; or governmental, building, environmental and safety codes, restrictions or requirements? | <input type="checkbox"/> | <input checked="" type="checkbox"/> | <input type="checkbox"/> |
| (o) If any answer to questions 10(a) - 10(n) is yes, please explain: _____ | | | |

11. Foreign Investment in Real Property Tax Act ("FIRPTA")

- (a) Is the Seller subject to FIRPTA withholding per Section 1445 of the Internal Revenue Code?

☐ ☒ ☐

If yes, Buyer and Seller should seek legal and tax advice regarding compliance.

12. ☐ (If checked) Other Matters; Additional Comments The attached addendum contains additional information, explanation, or comments.

Seller represents that the information provided on this form and any attachments is accurate and complete to the best of Seller's knowledge on the date signed by Seller. Seller authorizes listing broker to provide this disclosure statement to real estate licensees and prospective buyers of the Property. Seller understands and agrees that Seller will promptly notify Buyer in writing if any information set forth in this disclosure statement becomes inaccurate or incorrect.

Seller: Shawn J O'Keefe / Shawn J O'Keefe Date: 11-30-25
 (signature) (print)
 Seller: Danielle O'Keefe / Danielle O'Keefe Date: 11/30/25
 (signature) (print)

Buyer acknowledges that Buyer has read, understands, and has received a copy of this disclosure statement.

Buyer: _____ / _____ Date: _____
 (signature) (print)
 Buyer: _____ / _____ Date: _____
 (signature) (print)

Seller SOK DOK and Buyer () () acknowledge receipt of a copy of this page, which is Page 4 of 4.

SPDR-3 Rev 2/20
 Serial#: 005737-300158-6207788

©2020 Florida Realtors®

Form
 Simplicity

Flood Disclosure

Florida Statute 689.302 requires a seller to complete and provide a flood disclosure to a purchaser of residential real property **at or before** the time the sales contract is executed.

Seller, Shawn O'Keefe, Danielle N O'Keefe, provides Buyer the following flood disclosure **at or before** the time the sales contract is executed.

Property address: 2525 Forest Run Dr, Melbourne, FL 32935

Seller, please check the applicable boxes in paragraphs (1) through (3) below.

FLOOD DISCLOSURE

Flood Insurance: Homeowners' insurance policies do not include coverage for damage resulting from floods. Buyer is encouraged to discuss the need to purchase separate flood insurance coverage with Buyer's insurance agent.

- (1) Seller ☐ has ☒ has no knowledge of any flooding that has damaged the property during Seller's ownership of the property.
- (2) Seller ☐ has ☒ has not filed a claim with an insurance provider relating to flood damage on the property, including, but not limited to, a claim with the National Flood Insurance Program.
- (3) Seller ☐ has ☒ has not received assistance for flood damage to the property, including, but not limited to, assistance from the Federal Emergency Management Agency.
- (4) For the purposes of this disclosure, the term "flooding" means a general or temporary condition of partial or complete inundation of the property caused by any of the following:
 - a. The overflow of inland or tidal waters.
 - b. The unusual and rapid accumulation of runoff or surface waters from any established water source, such as a river, stream, or drainage ditch.
 - c. Sustained periods of standing water resulting from rainfall.

Seller: Shawn O'Keefe Shawn O'Keefe

Date: 11/20/2025

Seller: Danielle N O'Keefe Danielle N O'Keefe

Date: 11/19/2025

Copy provided to Buyer on 12/01/2025 by ☒ email ☐ facsimile ☐ mail ☐ personal delivery.

COMPASS

Comprehensive Rider to the Residential Contract For Sale And Purchase

THIS FORM HAS BEEN APPROVED BY THE FLORIDA REALTORS AND THE FLORIDA BAR



When initialed by all parties, the parties acknowledge that the disclosure set forth below was provided to Buyer prior to execution of the Florida Realtors/Florida Bar Residential Contract For Sale and Purchase between the parties and the clauses below will be incorporated therein:

_____ *Shawn O'Keefe, Danielle N O'Keefe* _____ (SELLER)
and _____ (BUYER)
concerning the Property described as 2525 Forest Run Dr, Melbourne, FL 32935

Buyer's Initials _____

Seller's Initials

SD

DND

B. HOMEOWNERS' ASSOCIATION/COMMUNITY DISCLOSURE

PART A. DISCLOSURE SUMMARY

IF THE DISCLOSURE SUMMARY REQUIRED BY SECTION 720.401, FLORIDA STATUTES, HAS NOT BEEN PROVIDED TO THE PROSPECTIVE PURCHASER BEFORE EXECUTING THIS CONTRACT FOR SALE, THIS CONTRACT IS VOIDABLE BY BUYER BY DELIVERING TO SELLER OR SELLER'S AGENT OR REPRESENTATIVE WRITTEN NOTICE OF THE BUYER'S INTENTION TO CANCEL WITHIN 3 DAYS AFTER RECEIPT OF THE DISCLOSURE SUMMARY OR PRIOR TO CLOSING, WHICHEVER OCCURS FIRST. ANY PURPORTED WAIVER OF THIS VOIDABILITY RIGHT HAS NO EFFECT. BUYER'S RIGHT TO VOID THIS CONTRACT SHALL TERMINATE AT CLOSING.

BUYER SHOULD NOT EXECUTE THIS CONTRACT UNTIL BUYER HAS RECEIVED AND READ THIS DISCLOSURE.

Disclosure Summary For Wickham Forest Phase 1
(Name of Community)

1. AS A BUYER OF PROPERTY IN THIS COMMUNITY, YOU WILL BE OBLIGATED TO BE A MEMBER OF A HOMEOWNERS' ASSOCIATION ("ASSOCIATION").
2. THERE HAVE BEEN OR WILL BE RECORDED RESTRICTIVE COVENANTS ("COVENANTS") GOVERNING THE USE AND OCCUPANCY OF PROPERTIES IN THIS COMMUNITY.
3. YOU WILL BE OBLIGATED TO PAY ASSESSMENTS TO THE ASSOCIATION. ASSESSMENTS MAY BE SUBJECT TO PERIODIC CHANGE. IF APPLICABLE, THE CURRENT AMOUNT IS \$ 250.00 PER year. YOU WILL ALSO BE OBLIGATED TO PAY ANY SPECIAL ASSESSMENTS IMPOSED BY THE ASSOCIATION. SUCH SPECIAL ASSESSMENTS MAY BE SUBJECT TO CHANGE. IF APPLICABLE, THE CURRENT AMOUNT IS \$ _____ PER _____.
4. YOU MAY BE OBLIGATED TO PAY SPECIAL ASSESSMENTS TO THE RESPECTIVE MUNICIPALITY, COUNTY, OR SPECIAL DISTRICT. ALL ASSESSMENTS ARE SUBJECT TO PERIODIC CHANGE.
5. YOUR FAILURE TO PAY SPECIAL ASSESSMENTS OR ASSESSMENTS LEVIED BY A MANDATORY HOMEOWNERS' ASSOCIATION COULD RESULT IN A LIEN ON YOUR PROPERTY.
6. THERE MAY BE AN OBLIGATION TO PAY RENT OR LAND USE FEES FOR RECREATIONAL OR OTHER COMMONLY USED FACILITIES AS AN OBLIGATION OF MEMBERSHIP IN THE HOMEOWNERS' ASSOCIATION. IF APPLICABLE, THE CURRENT AMOUNT IS \$ _____ PER _____.
7. THE DEVELOPER MAY HAVE THE RIGHT TO AMEND THE RESTRICTIVE COVENANTS WITHOUT THE APPROVAL OF THE ASSOCIATION MEMBERSHIP OR THE APPROVAL OF THE PARCEL OWNERS.
8. THE STATEMENTS CONTAINED IN THIS DISCLOSURE FORM ARE ONLY SUMMARY IN NATURE, AND, AS A PROSPECTIVE PURCHASER, YOU SHOULD REFER TO THE COVENANTS AND THE ASSOCIATION GOVERNING DOCUMENTS BEFORE PURCHASING PROPERTY.
9. THESE DOCUMENTS ARE EITHER MATTERS OF PUBLIC RECORD AND CAN BE OBTAINED FROM THE RECORD OFFICE IN THE COUNTY WHERE THE PROPERTY IS LOCATED, OR ARE NOT RECORDED AND CAN BE OBTAINED FROM THE DEVELOPER.

DATE _____

BUYER _____

DATE _____

BUYER _____

B. HOMEOWNERS' ASSOCIATION/COMMUNITY DISCLOSURE (CONTINUED)**PART B.**

The Property is located in a community with a mandatory homeowners' association or an association that may require the payment of assessments, charges, or impose restrictions on the Property ("Association").

1. APPROVAL: The Association's approval of Buyer (**CHECK ONE**): ☐ is ☒ is not required. If Association approval of this transaction or the Buyer is required, this Contract is contingent upon Association approval no later than _____ (if left blank, then 5) days prior to Closing. Within _____ (if left blank, then 5) days after Effective Date, the Seller shall initiate the approval process with Association. Buyer shall pay application and related fees, as applicable, unless otherwise provided for in Association governing documents or agreed to by the parties. Buyer and Seller shall sign and deliver any documents required by the Association, provide for interviews or personal appearances, if required, and use diligent effort to timely obtain Association approval. If approval is not granted within the stated time period above, Buyer may terminate this Contract, and shall be refunded the Deposit, thereby releasing Buyer and Seller from all further obligations under this Contract.

2. PAYMENT OF FEES, ASSESSMENTS, AND OTHER ASSOCIATION CHARGES:

(a) Buyer shall pay any application, initial contribution, and/or membership or other fees charged by Association pursuant to its governing documents or applicable Florida Statutes. If applicable, the current amount(s) is:

\$ _____ per _____ for _____ to _____
 \$ _____ per _____ for _____ to _____
 \$ _____ per _____ for _____ to _____
 \$ _____ per _____ for _____ to _____

(b) If special or other assessments levied by the Association exist as of the Effective Date, or any assessment(s) are levied after the Effective Date and prior to the Closing Date, and are due and payable in full prior to Closing Date, then Seller shall pay all such assessment(s) prior to or at Closing; or, if any such assessment(s) may be paid in installments, then Seller shall pay all installments which are due before Closing Date, prior to or at Closing, and (**CHECK ONE**): ☐ Buyer ☐ Seller (if left blank, then Buyer) shall pay installments due after Closing Date. **If Seller is checked, Seller shall pay the assessment in full prior to or at the time of Closing.**

(c) Seller shall pay, prior to or at Closing, all fines imposed against the Seller or the Property by the Association which exist as of the Closing Date and any fees the Association charges to provide information about the Property, assessment(s) and fees.

The Association or Management Company to which assessments, special assessments or rent/land use fees are due and payable, is/are:

Wickham Forest HOA

Contact Person Chip Osborne, President

Phone _____

Email chipwfhoa@gmail.com

Contact person _____

Phone _____

Email _____

Additional contact information can be found on the Association's website, which is:

www. wickhamforesthoa.com

CARPENTER | KESSEL
HOMESELLING TEAM

HOA Information

Required Information for Prospective Buyers

Property Information

Address:	2525 Forest Run Dr. Melbourne FL 32935
----------	--

HOA Information

Property Management Company:	N/A		Property Management Website:	N/A	
Contact Name:	N/A		Contact Phone Number:	N/A	
Contact Email:	wf-hoa@googlegroups.com				
Community/Association Website:	wickhamforesthoa.com		HOA Fees Frequency:	\$245.00 annually	
What does the Association Fee Include?	maintenance of common areas				
Community Amenities:	N/A			55+ Community:	Yes <input type="radio"/> No <input checked="" type="radio"/>
Pending Assessments:	Yes <input type="radio"/> No <input checked="" type="radio"/>	If Yes, Explain and Provide the Assessment Amount:			
N/A					

Buyer Information

Buyer Approval:	Yes <input type="radio"/> No <input checked="" type="radio"/>	**If Yes, Please Provide the Form**	Buyer Approval Fee Amt:	N/A	
Buyer Approval Acceptance Period:	N/A				
First Right of Refusal:	Yes <input type="radio"/> No <input checked="" type="radio"/>	**If Yes, Please Provide the Form**	First Right of Refusal Fee Amt:	N/A	
First Right of Refusal Acceptance Period:	N/A				

Rental Restrictions

Rentals Allowed:	Yes <input checked="" type="radio"/> No <input type="radio"/>	Tenant Approval:	Yes <input type="radio"/> No <input checked="" type="radio"/>	**If Yes, Please Provide the Form**	Tenant Approval Fee Amt:
					N/A
Lease Allowed During 1 st Year:	Yes <input checked="" type="radio"/> No <input type="radio"/>	Rental Period Minimum:	N/A		
		Additional Info:	N/A		

Misc Restrictions

Pet Restrictions:	Yes <input type="radio"/> No <input checked="" type="radio"/>	Total # of Pets Allowed:	N/A		Weight Limit:	N/A		Type of Pets Allowed:	N/A	
In-Ground Pool Installs Allowed:	Yes <input checked="" type="radio"/> No <input type="radio"/>	RV/Boat Parking Allowed:	Yes <input type="radio"/> No <input checked="" type="radio"/>	Fencing Allowed:	Yes <input checked="" type="radio"/> No <input type="radio"/>	Truck Parking Allowed:	Yes <input checked="" type="radio"/> No <input type="radio"/>	unless shielded by fence		
For Sale Signs Allowed:	Yes <input checked="" type="radio"/> No <input type="radio"/>	Explain Special Sign Requirements:	NA			For Condo's, Specific Location for Lockbox Placement:	N/A			

Required Documentation – The Agent Must Receive the Following Documentation within 72 hours of the Signed Listing Agreement

Email the Following Documents Directly to Your Agent OR to Cecily@CarpenterKessel.com:
Declarations
Rules & Regulations
By Laws
Amendments
Financial Documents Including Budget & Reserves (Condo's Only)
Meeting Minutes - Last Three Meetings (Condo's Only)

Seller 1 Signature:

Date:

11.30.25

Seller 2 Signature:

Date:

11/19/25

Property Features & Upgrades: 2525 Forest Run Dr

Interior

- Custom built-in office cabinetry with hidden monitor storage & 8' closet door
- 48" dual-fuel double oven range with custom wood vent hood & pot filler
- Walk-in pantry with custom faux cabinetry design
- Kitchen skylights + under-cabinet lighting
- Expanded recessed lighting throughout living room, office & kitchen
- Luxurious primary bathroom: marble tile, dual shower heads + rain + handheld
- Color-sealed grout on wood-plank tile flooring
- Custom trim upgrades on all windows & doors
- Newer (2022) carpet in upstairs bedrooms
- Upstairs flex space with bathroom access
- Fully updated upstairs bathroom: tub, tile, vanity, flooring & trim
- Laundry room with brick flooring & shiplap ceiling

Exterior

- New Hardie Board siding on front exterior (2024)
- Fresh exterior paint (2024)
- New 8' French door slider (2024)
- Pavered screened-in porch with T&G ceiling, recessed lighting & fan outlets

Design & Construction

- Styled by MG Interiors
- Kitchen, bathroom & office renovations completed by Caliber Construction

CARPENTER | KESSEL
HOMESELLING TEAM

PERSONAL PROPERTY INVENTORY

Seller 1: Shawn O'Keefe	Seller 2: Danielle O'Keefe
Property Address: 2525 Forest Run Dr. Melbourne FL 32935	

This addendum is referenced in the Contract for Purchase and Sale between parties that have signed below and is incorporated therein by reference. The personal property included in the purchase price and listed below shall be the same property existing on the property as of the date of initial offer, with no substitutions unless agreed upon by the parties in writing. Be as specific as possible. Make an entry for EACH item.

YES = It's on the property and WILL CONVEY | NO = It's on the property and WILL NOT convey | N/A = It's NOT ON THE PROPERTY and doesn't apply

Item	Yes	No	N/A
Range (Oven & Cooktop): <input checked="" type="checkbox"/> Electric <input checked="" type="checkbox"/> Gas ----- OR ----- dual	<input checked="" type="checkbox"/>		
Wall Oven(s): <input type="checkbox"/> Electric <input type="checkbox"/> Gas ----- AND -----			<input checked="" type="checkbox"/>
Cooktop: <input type="checkbox"/> Electric <input type="checkbox"/> Gas			<input checked="" type="checkbox"/>
Refrigerator with Freezer	<input checked="" type="checkbox"/>		
Microwave Oven	<input checked="" type="checkbox"/>		
Dishwasher	<input checked="" type="checkbox"/>		
Disposal	<input checked="" type="checkbox"/>		
Water Softener Purifier <input type="checkbox"/> Owned <input type="checkbox"/> Leased			<input checked="" type="checkbox"/>
Bar Refrigerator			<input checked="" type="checkbox"/>
Separate Refrigerator Freezer Stand Alone Ice Maker		<input checked="" type="checkbox"/>	
Wine Cooler			<input checked="" type="checkbox"/>
Compactor			<input checked="" type="checkbox"/>
Washer	<input checked="" type="checkbox"/>		
Dryer: <input type="checkbox"/> Electric <input type="checkbox"/> Gas	<input checked="" type="checkbox"/>		
Chandelier/Hanging Lamp Qty 8	<input checked="" type="checkbox"/>		
Ceiling Paddle Fan Qty 6	<input checked="" type="checkbox"/>		Exclude: porch
Sconce(s): Qty 3	<input checked="" type="checkbox"/>		<input checked="" type="checkbox"/>
Draperies: Qty 2 Rods: Qty 2 master	<input checked="" type="checkbox"/>		
Plantation Shutters: Qty			<input checked="" type="checkbox"/>
Shades Blinds: Qty	<input checked="" type="checkbox"/>		exclude: master closet, master w.c., front door
Mirrors Location: Bathrooms	<input checked="" type="checkbox"/>		
Fireplace(s) Qty <input type="checkbox"/> Wood Burning <input type="checkbox"/> Gas <input type="checkbox"/> Both			<input checked="" type="checkbox"/>
Boat Lift: Weight <input type="checkbox"/> Davits: <input type="checkbox"/> Electric <input type="checkbox"/> Manual			<input checked="" type="checkbox"/>
Appliances Leased Describe:			<input checked="" type="checkbox"/>
Pool Table Game Table			<input checked="" type="checkbox"/>

Item	Yes	No	N/A
Water Heater(s): Qty 1 <input type="checkbox"/> Tankless <input checked="" type="checkbox"/> Gas <input type="checkbox"/> Electric	<input checked="" type="checkbox"/>		
Generator: <input type="checkbox"/> Electric <input type="checkbox"/> Propane <input type="checkbox"/> Natural Gas			<input checked="" type="checkbox"/>
Storm Shutters Panels: <input type="checkbox"/> Electric <input checked="" type="checkbox"/> Manual <input type="checkbox"/> Both	<input checked="" type="checkbox"/>		
Awnings: <input type="checkbox"/> Electric <input type="checkbox"/> Manual			<input checked="" type="checkbox"/>
Propane Tank: <input type="checkbox"/> Owned <input type="checkbox"/> Leased			<input checked="" type="checkbox"/>
Central Vac System Equip + Accessories			<input checked="" type="checkbox"/>
Security Gate Remotes(s): Qty			<input checked="" type="checkbox"/>
Garage Door Opener(s): Qty 1	<input checked="" type="checkbox"/>		
Garage Door Remote(s): Qty			<input checked="" type="checkbox"/>
Smart Doorbell	<input checked="" type="checkbox"/>		
Smart Thermostat(s) Qty 1	<input checked="" type="checkbox"/>		
Summer Kitchen Grill			<input checked="" type="checkbox"/>
Pool: <input type="checkbox"/> Salt <input type="checkbox"/> Chlorine			<input checked="" type="checkbox"/>
Pool Heater: <input type="checkbox"/> Gas <input type="checkbox"/> Elec <input type="checkbox"/> Solar			<input checked="" type="checkbox"/>
Hot Tub Spa: Heated: Yes No			<input checked="" type="checkbox"/>
Pool Cleaning Equipment			<input checked="" type="checkbox"/>
Pool - Child Fence Barrier			<input checked="" type="checkbox"/>
Storage Shed	<input checked="" type="checkbox"/>		
Potted Plants Lawn Ornaments Fountains	<input checked="" type="checkbox"/>		exclude: front porch planters and backyard planters (raised)
Intercom			<input checked="" type="checkbox"/>
TV's: Qty TV Mounts: Qty		<input checked="" type="checkbox"/>	
Security System: <input type="checkbox"/> Owned <input type="checkbox"/> Leased Cameras: <input type="checkbox"/> Yes <input type="checkbox"/> No			<input checked="" type="checkbox"/>
Surround Sound (With Components) Speakers: <input type="checkbox"/> Yes <input type="checkbox"/> No			<input checked="" type="checkbox"/>
Satellite Dish TV Antenna <input type="checkbox"/> Leased <input checked="" type="checkbox"/> Owned	<input checked="" type="checkbox"/>		
Other Notes:			

Seller 1: Shawn O'Keefe Date: 11-19-25 Buyer 1: _____ Date: _____Seller 2: Danielle O'Keefe Date: 11/19/25 Buyer 2: _____ Date: _____



CARPENTER | KESSEL
HOMESELLING TEAM

FREQUENTLY ASKED QUESTIONS

Important Information for Prospective Buyers

Property Information

Address: 2525 Forest Run Dr. Melbourne FL 32935			
Home Warranty: Yes <input checked="" type="radio"/> No		If yes, Company Number:	
Lawn Service Number: Viera Lawn Care (321) 390-2204		Pool Company Number: N/A	
Pest Company Number: Beachside Termite & Pest Control (321) 750-4100		Termite Company Number: N/A	Transferable Bond: Yes <input checked="" type="radio"/> No

Utility Information

Trash Pick-Up Days Tuesday & Friday	Trash: Friday	Yard: Wednesday	Recycle:
Approximate Utility Cost Per Month Electric: \$200.00		Gas: \$70.00	Water: \$100.00
Water Source: <input checked="" type="radio"/> City Water	Well	Sprinkler System Runs On: <input checked="" type="radio"/> Well	City Reclaimed
Plumbing Source: <input checked="" type="radio"/> Sewer	Septic	Septic Location: N/A	

Property Specifics

Roof Age: 10 yrs.	Heating & A/C System Age: 5 yrs.	Water Heater Age: 4 yrs
Water Depth at Dock: N/A	Waterfront Footage: N/A	Type of Fencing: Wood
Type of Flooring: tile / carpet	Type of Countertops: quartz	
<p>Property Features Updates Year: Deficiencies:</p> <p>Outdoor gas Lamppost - functional but needs new glass panels and mantles</p> <p>wired doorbell non functional</p>		

Are You Providing a Copy of:

Wind Mitigation: Yes <input checked="" type="radio"/> No	Four-Point Inspection: Yes <input checked="" type="radio"/> No	Survey: Yes <input checked="" type="radio"/> No
Insurance Declaration Page: Yes <input checked="" type="radio"/> No	Approximate Insurance Cost Per Year:	

Seller 1 Signature:

[Signature]

Date:

11.30.25

Seller 2 Signature:

[Signature]

Date:

11/19/25

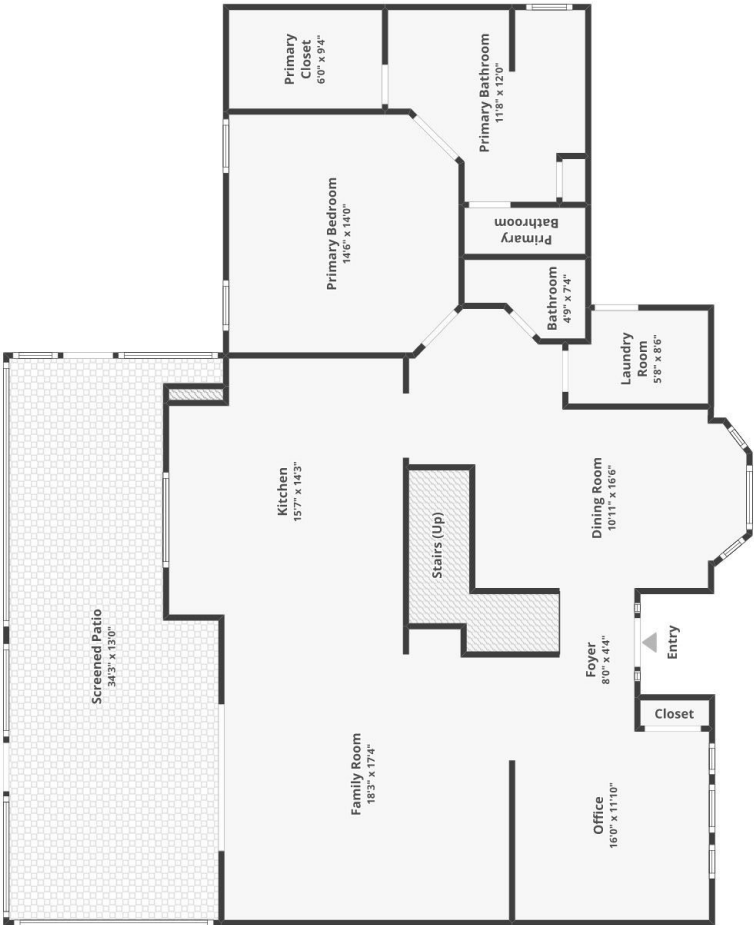

FLOOR 1



FLOOR 2